

Greenacres

---

Shoreham-By-Sea





We know just the place...



This wonderful three-bedroom terraced house with a garden and private garage is located in Shoreham-By-Sea. Set away from the road, the property is brilliantly quiet and very spacious. Greenacres is excellently positioned within Shoreham; a ten-minute walk from Shoreham Station, ideal for anyone commuting to London.

On entering the property, a hallway provides access to all ground floor rooms. Immediately to the right is the large reception/ dining room, which is a brilliant size and beautifully lit by a large bay window. The room has stunning wooden flooring and double doors that allow access to the garden. Next is the good size kitchen. On the first floor, there are three good size bedrooms, each is well lit. The master bedroom is very spacious and includes built-in storage space and a large bay window. There is also a modern family bathroom, with both shower and bath facilities.

The property benefits from a spacious garden which has a patio area and a lawn. There is also a private garage.

Greenacres is situated just outside of Shoreham Town Centre; less than ten minutes' walk to a fantastic range of shops, bars, restaurants and cafes.





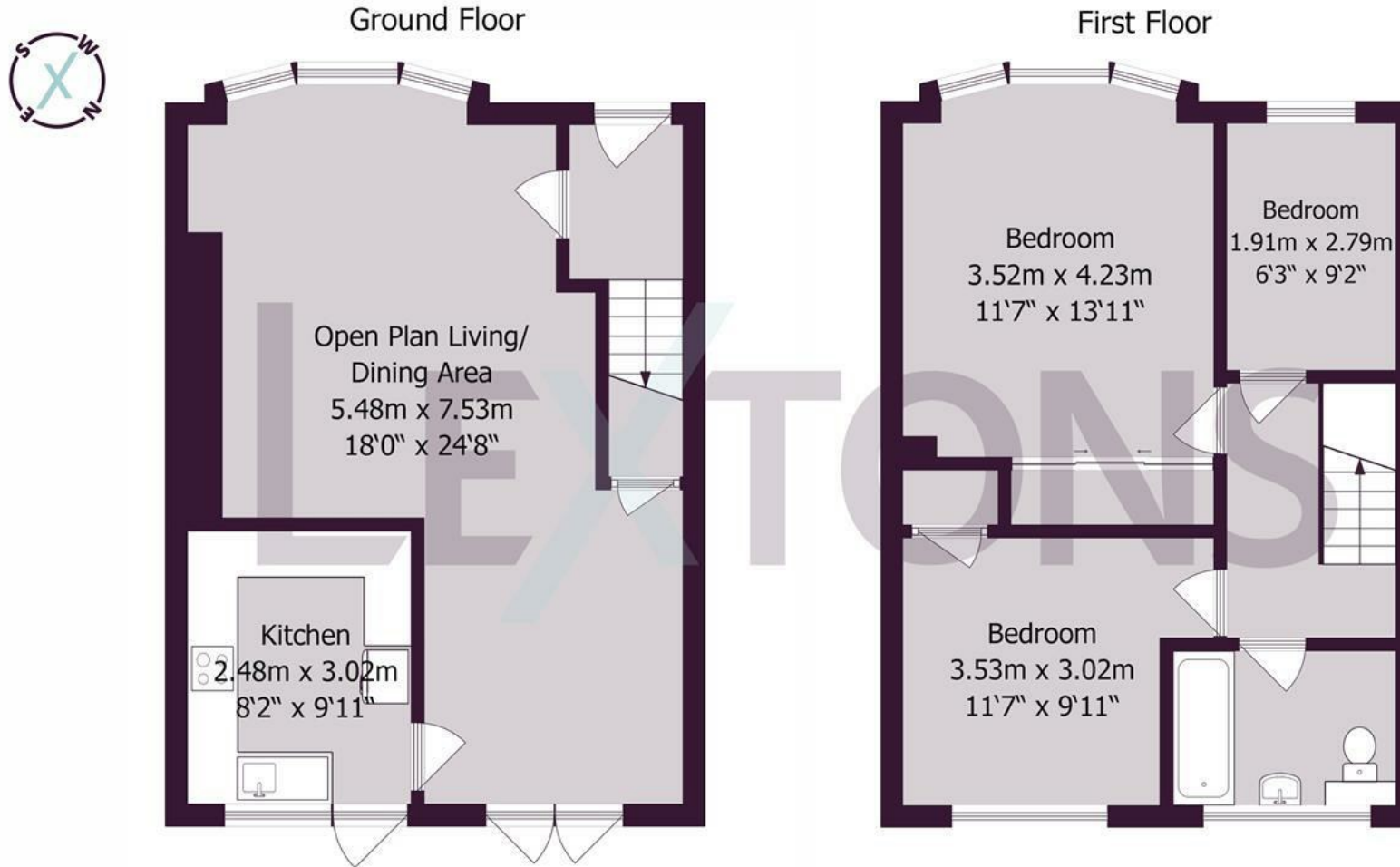

Approximate gross internal floor area 88 sq m/ 947 sq ft

Whilst every care has been taken to ensure accuracy, dimensions are approximate and for illustrative purposes only.

Created by Property Photography UK for Lextons. All rights reserved.

Meet us here...  
174 Church Road  
Hove  
BN3 2DJ

We aim to make our particulars both accurate and reliable. However they are not guaranteed; nor do they form part of an offer or contract. If you require clarification on any points then please contact us, especially if you're traveling some distance to view. Please note that appliances and heating systems have not been tested and therefore no warranties can be given as to their good working order.